



SUPERYACHT
TIMES.COM

Ghost Yachts present the G180 superyacht

Monday, 14 December 2009

The Dutch yacht company Ghost Yachts and Italian design company Gloss Design unveil their first project to the public, the Ghost Yachts G180. The yacht embodies the best of two of the leading superyacht building nations. An unmistakable refined Italian styling combined with cutting edge Dutch engineering and build technology.



The G180 represents Ghost Yachts' fresh philosophy of combining distinctive design with sustainable and innovative technology. Ghost Yachts has effectively incorporated its forward thinking approach to meet the requirements of modern yachting and live up to the challenges of 21st century yacht building.

The G180's design brief stated the desire to create a form that displays a sophisticated but uncomplicated design. It should be equally impressive and elegant. It also had to be instantly recognisable and friendly to build.

Gloss Design produced a form that cleverly incorporates these requirements without compromising construction methods or the need for a large amount of custom made components. The exterior styling distinguishes itself by using lighting angles to emphasise the shape. With its distinctive bow, 180' LOA and 30' beam the yacht displays its powerful yet graceful proportions. Gloss Design has also been careful with the incorporation of design details that could become the centre of attention. The result is a harmonious combination of clear lines and smooth surfaces without any frills or styling gimmicks.



Many technical options were reviewed before defining the technical layout of the yacht. The current issue of reducing the ecological impact of superyachts was taken into consideration by Ghost Yachts.

Popular hybrid diesel/electric options proved to be insufficiently sensible for the concept of the G180. To maintain the goal of emissions reduction Ghost Yachts contacted the renowned Dutch Naval Architects Van Oossanen & Associates. Over the past 10 years Van Oossanen have developed the Fast Displacement Hull Form. The hull form has less resistance compared to other hull forms commonly used, and also offers the possibility to reach semi-displacement speeds in excess of 20 knots.



The input and experiences of industry professionals like captains, brokers and crew members proved themselves to be a highly valuable asset during the development of the G180. Various layouts have been tried and tested and Ghost Yachts decided to present a preliminary layout that will inspire owners to rethink the way they arrange their yachts rather than offering a fixed standard option. The yacht is developed as a semi-custom platform that allows flexibility in the interior layout.

The vertical bow configuration not only resulted in improved seakeeping capabilities, it also offered a larger interior volume in the forward part of the lower and main deck. The benefits of the extra space resulted in larger crew accommodations and a tender storage on the main deck that can hold an 8.5 metre guest tender and a 6 metre crew tender. The preliminary layout shows logical onboard logistics for both crew and guests. The layout emphasizes its flexibility by rearranging the usual location of the cabins.



The owners' stateroom, for example, has been relocated to the upper deck where it offers more natural light, better views on the yacht's surroundings and a more flexible way to use the second salon at the aft. It can either be used as an annex for the owners' stateroom or separated from the stateroom in case extra space is required for social events. The generous guest rooms have been planned on the forward main deck where they efficiently use the available space.

The lower deck offers two VIP suites which offer an unsurpassed living area. Both suites are equipped with a separate lounge where the guests can enjoy a private moment after an exhilarating day at sea.

The G180's technical platform has been developed to be as sustainable and production friendly as possible. A lifecycle analysis was used as the foundation of the technical layout.

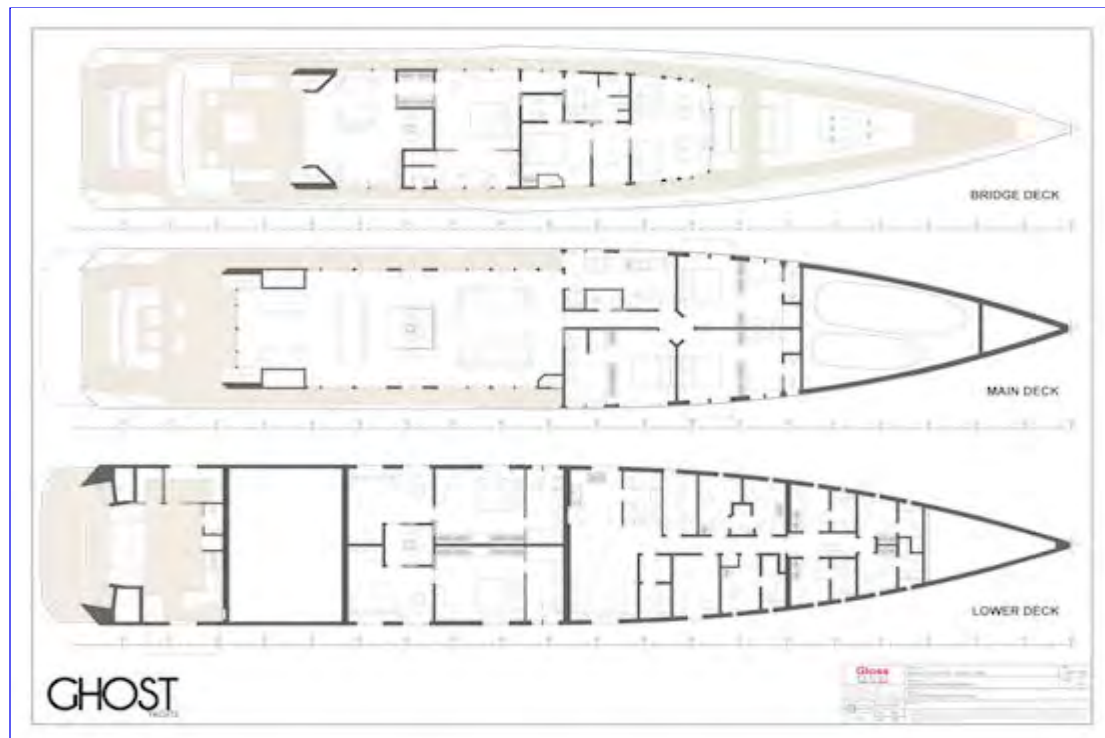

The choice of materials, their country of origin and location of production are key issues that have been taken into consideration during the development.

Ghost Yachts are developed to meet modern construction technologies, as used at other renowned Dutch and German shipyards. This guarantees that a Ghost superyacht will meet the highest quality standards, offer excellent finishing and good value preservation.

The production engineering of the Ghost Yachts' G180 is scheduled to be completed by the end of 2010.

Ghost Yachts

Björn Moonen

+31 (0)641 209081

moonen@ghost-yachts.com

www.ghost-yachts.com

Gloss Design Italy

Stefano Carugno

+39 (0)85 9151070

mail@glossdesign.it

www.glossdesign.it